

SIGN	DATE	DESCRIPTION	APPROVER
▲	03.4.22	The dimension is changed from 46.57 to 42.30	King
▲	03.4.22	The dimension is changed from 46.57 to 40.75	King

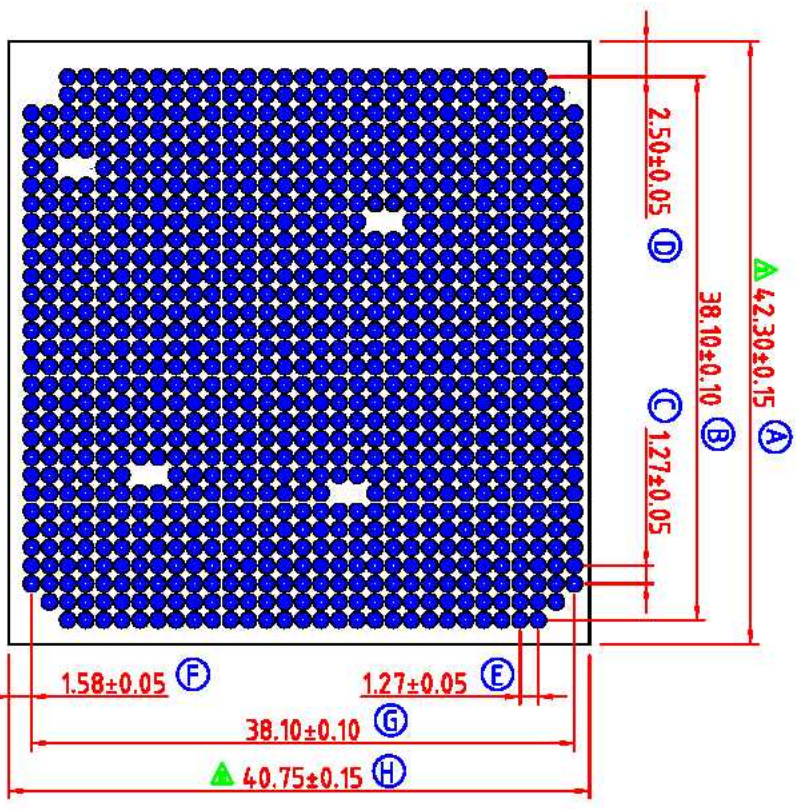

SP 2760 X 2

PGA 31x31 CONTACT: 940 Pin FootPrint: 76

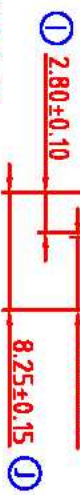

- Material**
- Pin : Brass, Machined
 - Outer sleeve : CuZn36pb2
 - Clip : Beryllium Copper, heat treated
- (contact 6--finger)
- Plating pin : Tin plated: 2um/80u"nickel,5um/200u"tin (outersleeve)
 - Gold plated: Cu260u"Ni50u"+Au3u"
 - plating clip : Ni 50u"+G/F
 - (contact) : gold and tin plating see table below
 - Insulator body : FR-4
- Electrical**
- Current rating :3Amps/contact max.
 - Contact resistance: ≤4mΩ /contact
 - Insulation resistance: ≥1KMR at V=100V
 - Operating Voltage:60 Vac/DC
- Mechanical**
- Average Insertion: ≤60g
 - force with steel pin of φ0.30mm/0.12"
 - Average with:- ≥20g
 - force with steel pin of φ0.31mm/.012"
 - Mechanical life min:200 cycle
 - Operating : Gold plated :
 - temperatures -55°C to +125°C
 - (continuous) Tin plated : -40°C to +105°C
 - Soldering temperature: +260°C, 10s max. +500°F 10s max.
- Applications and Features**
- Low insertion force socket. 6 fingers contacts
 - Closed end construction for 100% anti-wicking of solder.

Code	Clip plated	Pin plated
0	Gold flash	Tin 200u"
1	Gold 10u"	Tin 200u"
2	Gold 30u"	Tin 200u"
3	Tin 200u"	Tin 200u"
4	Gold flash	Gold 3u"
5	Gold 10u"	Gold 3u"
6	Gold 30u"	Gold 3u"

PART NAME: SP-PGA 940P 8.25mm PIN		TITLE:	
PART NO: SP2760X2		DWG NAME: SP0035A1.DWG-940	
APPROVED BY	CHECKED BY	DESIGNED BY	DRAWN BY
	馬華春		2004.07.16
UNITS: mm		Tolerance	
SCALE: 2:1		X. ±0.50	
REVISION: A1		X.X ±0.30	
		X.XX ±0.10	
		X" ±1"	